

- Tube Fitting (Double Ferrule)-
Tube To Female Pipe Thread

Female Connector

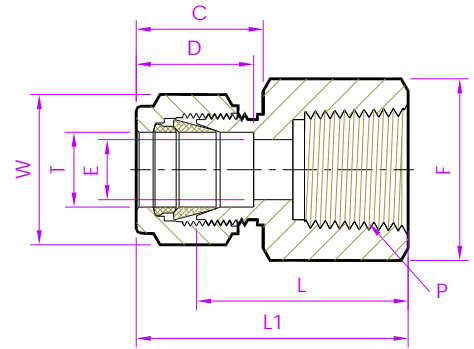

Metric Tube x NPT (F)

TubeFit Part No.	Equivalent Part No. Type 1	Equivalent Part No. Type 2	TUBE OD Ø T	NPT Female Pipe Size P	ØE	D	C	L	L1	Body Hex F	Nut Hex W
			(mm)	(Inch)	Dimensions in Millimetres						
3M - FCD - 2N	- 3MO - 7 - 2	M3FSC1/8N	3	1/8	2.4	12.9	15.3	22.1	28.7	14.2	11.1
3M - FCD - 4N	- 3MO - 7 - 4	M3FSC1/4N	3	1/4	2.4	12.9	15.3	26.9	33.5	19	11.1
4M - FCD - 2N	- 4MO - 7 - 2	M4FSC1/8N	4	1/8	2.4	13.7	16.1	23.1	29.7	14.2	11.1
6M - FCD - 2N	- 6MO - 7 - 2	M6FSC1/8N	6	1/8	4.8	15.3	17.7	23.9	31.3	14.2	14.2
6M - FCD - 4N	- 6MO - 7 - 4	M6FSC1/4N		1/4	4.8			28.4	35.8	19	
6M - FCD - 6N	- 6MO - 7 - 6	M6FSC3/8N		3/8	4.8			30.2	37.6	22.2	
6M - FCD - 8N	- 6MO - 7 - 8	M6FSC1/2N		1/2	4.8			35.1	42.5	27	
8M - FCD - 2N	- 8MO - 7 - 2	M8FSC1/8N	8	1/8	6.4	16.2	18.6	24.6	32.1	16	16
8M - FCD - 4N	- 8MO - 7 - 4	M8FSC1/4N		1/4	6.4			29.5	37.0	19	
8M - FCD - 6N	- 8MO - 7 - 6	M8FSC3/8N		3/8	6.4			31.0	38.5	22.2	
8M - FCD - 8N	- 8MO - 7 - 8	-----		1/2	6.4			35.8	43.3	27	
10M - FCD - 4N	- 10MO - 7 - 4	M10FSC1/4N	10	1/4	7.9	17.2	19.5	30.2	37.8	19	19
10M - FCD - 6N	- 10MO - 7 - 6	M10FSC3/8N		3/8	7.9			31.8	39.4	22.2	
10M - FCD - 8N	- 10MO - 7 - 8	M10FSC1/2N		1/2	7.9			36.6	44.2	27	
12M - FCD - 4N	- 12MO - 7 - 4	M12FSC1/4N	12	1/4	9.5	22.8	22.0	30.2	40.3	22.2	22.2
12M - FCD - 6N	- 12MO - 7 - 6	M12FSC3/8N		3/8	9.5			31.8	41.9	22.2	
12M - FCD - 8N	- 12MO - 7 - 8	M12FSC1/2N		1/2	9.5			36.6	46.7	27	
15M - FCD - 8N	- 15MO - 7 - 8	-----	15	1/2	11.9	24.4	22.0	36.6	46.7	27	25.4
16M - FCD - 6N	- 16MO - 7 - 6	M16FSC3/8N	16	3/8	9.5	24.4	22.0	31.8	41.9	27	25.4
16M - FCD - 8N	- 16MO - 7 - 8	M16FSC1/2N		1/2	12.7			36.8	46.9	27	
20M - FCD - 8N	- 20MO - 7 - 8	M20FSC1/2N	20	1/2	15.9	26.0	22.0	37.8	47.9	30	32
20M - FCD - 12N	- 20MO - 7 - 12	M20FSC3/4N		3/4	15.9			39.6	49.7	35	
22M - FCD - 12N	- 22MO - 7 - 12	M22FSC3/4N	22	3/4	18.3	26.0	22.0	39.6	49.7	35	32
22M - FCD - 16N	- 22MO - 7 - 16	-----		1	18.3			47.8	57.9	41	
25M - FCD - 12N	- 25MO - 7 - 12	M25FSC3/4N	25	3/4	21.8	31.3	26.5	41.1	53.4	35	38
25M - FCD - 16N	- 25MO - 7 - 16	M25FSC1N		1	21.8			50.0	62.3	41	

NOTE : 1)The E Dimension is the minimum opening. 2)Dimension L1, C, D is shown in the finger-tight position.
3)Dimensions are for reference only and are subject to change 4)NPT thread as per ANSI B 1.20.1.

- ALL PART NUMBERS ARE PROPRIETARY OF THEIR RESPECTIVE OWNERS. -