

- Tube Fitting (Double Ferrule)-
Tube To Female Pipe Thread

Female Elbow

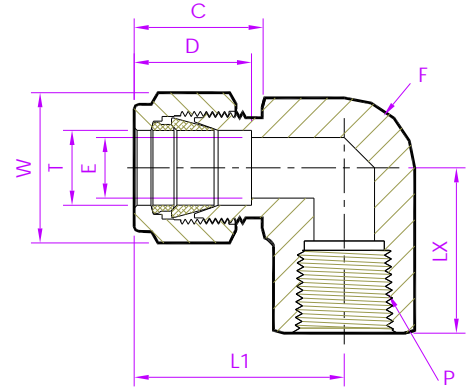

Metric Tube x NPT (F)

Tubefit Part No.	Equivalent Part No. Type 1	Equivalent Part No. Type 2	TUBE OD Ø T	NPT Female Pipe Size P	ØE	D	C	L1	LX	Body Hex F	Nut Hex W
			(mm)	(in)	Dimensions in Millimetres						
6M - FED - 2N	- 6MO - 8 - 2	M6FEL1/8N	6	1/8	4.8	15.3	17.7	27.0	19.0	14.2	14.2
6M - FED - 4N	- 6MO - 8 - 4	M6FEL1/4N		1/4	4.8			29.8	22.4	19	
6M - FED - 8N	- 6MO - 8 - 8	-----		1/2	4.8			34.6	28.4	27	
8M - FED - 2N	- 8MO - 8 - 2	M8FEL1/8N	8	1/8	4.8	16.2	18.6	28.8	19.1	16	16
8M - FED - 4N	- 8MO - 8 - 4	M8FEL1/4N		1/4	6.4			30.6	22.4	19	
10M - FED - 2N	- 10MO - 8 - 2	-----	10	1/8	7.9	17.2	19.5	31.5	19.0	17.4	19
10M - FED - 4N	- 10MO - 8 - 4	M10FEL1/4N		1/4	7.9			33.5	22.4	19	
10M - FED - 6N	- 10MO - 8 - 6	M10FEL3/8N		3/8	7.9			33.5	22.4	22.2	
10M - FED - 8N	- 10MO - 8 - 8	M10FEL1/2N		1/2	7.9			36.3	28.5	27	
12M - FED - 4N	- 12MO - 8 - 4	M12FEL1/4N	12	1/4	9.5	22.8	22.0	36.0	22.4	22.2	22.2
12M - FED - 6N	- 12MO - 8 - 6	M12FEL3/8N		3/8	9.5			36.0	22.4	22.2	
12M - FED - 8N	- 12MO - 8 - 8	M12FEL1/2N		1/2	9.5			38.8	28.4	27	
16M - FED - 6N	- 16MO - 8 - 6	M16FEL3/8N	16	3/8	9.5	24.4	22.0	39.5	23.6	25	25
16M - FED - 8N	- 16MO - 8 - 8	M16FEL1/2N		1/2	12.7			39.5	28.4	27	

NOTE : 1)The E Dimension is the minimum opening. 2)Dimension L1, C, D is shown in the finger-tight position.
3)Dimensions are for reference only and are subject to change 4)NPT thread as per ANSI B 1.20.1.

- ALL PART NUMBERS ARE PROPRIETARY OF THEIR RESPECTIVE OWNERS. -