

- Tube Fitting (Double Ferrule)-
 Tube To Male Pipe Thread

45° Male Elbow

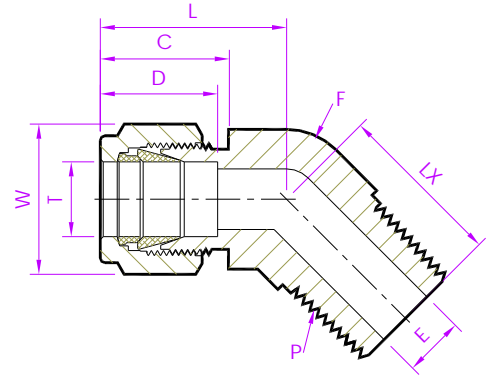
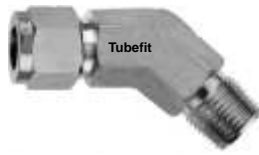

Fractional Tube x NPT (M)

Tubefit Part No.	Equivalent Part No. Type 1	Equivalent Part No. Type 2	TUBE OD Ø T	NPT Male Pipe Size P	ØE	D	C	L	LX	Body Hex F	Nut Hex W
Dimensions in Inches											
1 - 45MED - 1N	- 100 - 5 - 1	1MVEL1N	1/16	1/16	0.05	0.34	0.43	0.62	0.57	9/16	5/16
2 - 45MED - 2N	- 200 - 5 - 2	2MVEL2N	1/8	1/8	0.09	0.50	0.60	0.88	0.66	9/16	7/16
3 - 45MED - 2N	- 300 - 5 - 2	3MVEL2N	3/16	1/8	0.12	0.54	0.63	0.84	0.58	9/16	1/2
4 - 45MED - 2N	- 400 - 5 - 2	4MVEL2N	1/4	1/8	0.19	0.60	0.70	0.97	0.65	9/16	9/16
4 - 45MED - 4N	- 400 - 5 - 4	4MVEL4N		1/4	0.19			0.97	0.83	9/16	
5 - 45MED - 2N	- 500 - 5 - 2	5MVEL2N	5/16	1/8	0.19	0.64	0.64	1.01	0.66	9/16	5/8
6 - 45MED - 2N	- 600 - 5 - 2	6MVEL2N	3/8	1/8	0.19	0.66	0.76	1.10	0.72	5/8	11/16
6 - 45MED - 4N	- 600 - 5 - 4	6MVEL4N		1/4	0.28			1.10	0.90	5/8	
6 - 45MED - 6N	- 600 - 5 - 6	6MVEL6N		3/8	0.28			1.15	0.95	13/16	
8 - 45MED - 6N	- 810 - 5 - 6	8MVEL6N	1/2	3/8	0.38	0.90	0.86	1.26	0.95	13/16	7/8
8 - 45MED - 8N	- 810 - 5 - 8	-----		1/2	0.41			1.26	1.14	7/8	
10 - 45MED - 8N	- 1010 - 5 - 8	10MVEL8N	5/8	1/2	0.47	0.96	0.86	1.29	1.17	7/8	1
12 - 45MED - 12N	- 1210 - 5 - 12	12MVEL12N	3/4	3/4	0.62	0.96	0.86	1.34	1.22	1.1/16	1.1/8
14 - 45MED - 12N	- 1410 - 5 - 12	14MVEL12N	7/8	3/4	0.62	1.02	0.86	1.36	1.27	1.5/16	1.1/4
16 - 45MED - 16N	- 1610 - 5 - 16	16MVEL16N	1	1	0.88	1.23	1.04	1.59	1.49	1.3/8	1.1/2

NOTE : 1)The E Dimension is the minimum opening & Fittings of this group may be back drilling to lager ID at pipe thread or straight thread end.
 2)Dimension L, C, D is shown in the finger-tight position. 3)Dimensions are for reference only and are subject to change 4)NPT thread as per ANSI B 1.20.1.

- ALL PART NUMBERS ARE PROPRIETARY OF THEIR RESPECTIVE OWNERS. -