

- Tube Fitting (Double Ferrule)-
Tube To Female Pipe Thread

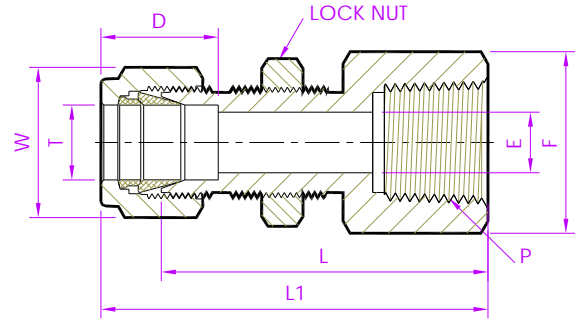

Bulkhead Female Connector

Fractional Tube x NPT (F)

Tubefit Part No.	Equivalent Part No. Type 1	Equivalent Part No. Type 2	TUBE OD Ø T	NPT Female Pipe Size P	ØE	D	C	L	L1	Body Hex F	Nut Hex W
Dimensions in Inches											
2 - BFGD - 2N	- 200 - 71 - 2	2FBC2N	1/8	1/8	0.09	0.50	0.60	1.50	1.76	9/16	7/16
3 - BFGD - 2N	- 300 - 71 - 2	3FBC2N	3/16	1/8	0.12	0.54	0.63	1.53	1.79	9/16	1/2
4 - BFGD - 2N	- 400 - 71 - 2	4FBC2N	1/4	1/8	0.19	0.60	0.70	1.56	1.85	9/16	9/16
4 - BFGD - 4N	- 400 - 71 - 4	4FBC4N		1/4	0.19			1.75	2.04	3/4	
5 - BFGD - 2N	- 500 - 71 - 2	5FBC2N	5/16	1/8	0.25	0.64	0.73	1.67	1.96	11/16	5/8
5 - BFGD - 8N	- 500 - 71 - 8	5FBC8N		1/2	0.25			2.09	2.38	1.1/16	
6 - BFGD - 4N	- 600 - 71 - 4	6FBC4N	3/8	1/4	0.28	0.66	0.76	1.88	2.17	3/4	11/16
8 - BFGD - 6N	- 810 - 71 - 6	8FBC6N	1/2	3/8	0.41	0.90	0.86	2.03	2.43	7/8	7/8
8 - BFGD - 8N	- 810 - 71 - 8	8FBC8N		1/2	0.41			2.22	2.62	1.1/16	
10 - BFGD - 8N	- 1010 - 71 - 8	10FBC8N	5/8	1/2	0.50	0.96	0.86	2.25	2.65	1.1/16	1
12 - BFGD - 12N	- 1210 - 71 - 12	12FBC12N	3/4	3/4	0.62	0.96	0.86	2.50	2.90	1.1/4	1.1/8
14 - BFGD - 12N	- 1410 - 71 - 12	14FBC12N	7/8	3/4	0.72	1.02	0.86	2.78	3.18	1.3/8	1.1/4
16 - BFGD - 16N	- 1610 - 71 - 16	16FBC16N	1	1	0.88	1.23	1.04	3.20	3.68	1.5/8	1.1/2

NOTE: 1)The E Dimension is the minimum opening. 2)Dimension L1, C, D is shown in the finger-tight position.
3)Dimensions are for reference only and are subject to change 4)NPT thread as per ANSI B 1.20.1.

- ALL PART NUMBERS ARE PROPRIETARY OF THEIR RESPECTIVE OWNERS. -