

- Tube Fitting (Double Ferrule)-
Tube To Male Pipe Thread

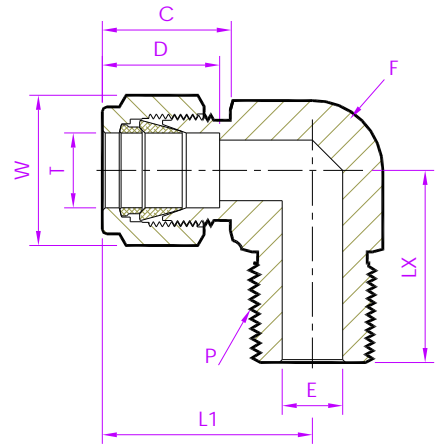

Male Elbow

Metric Tube x ISO Tapered (M)

| Tube Part No. | Equivalent Part No. Type 1 | Equivalent Part No. Type 2 | TUBE OD Ø T | ISO Male Pipe Size P | ØE | D | C | L1 | LX | Body Hex F | Nut Hex W |
|------------------|----------------------------|----------------------------|-------------|----------------------|---------------------------|------|------|------|------|------------|-----------|
| | | | (mm) | (In) | Dimensions in Millimetres | | | | | | |
| 6M - MED - 4IT | - 6MO - 2 - 4RT | M6MSEL1/4K | 6 | 1/4 | 4.8 | 15.3 | 17.7 | 27.0 | 23.4 | 15 | 14.2 |
| 6M - MED - 6IT | - 6MO - 2 - 6RT | M6MSEL3/8K | | 3/8 | 4.8 | | | 29.8 | 26.2 | 17.5 | |
| 6M - MED - 8IT | - 6MO - 2 - 8RT | M6MSEL1/2K | | 1/2 | 4.8 | | | 31.8 | 33.0 | 22.5 | |
| 8M - MED - 4IT | - 8MO - 2 - 4RT | M8MSEL1/4K | 8 | 1/4 | 6.4 | 16.2 | 18.6 | 28.8 | 24.4 | 15 | 16 |
| 8M - MED - 6IT | - 8MO - 2 - 6RT | M8MSEL3/8K | | 3/8 | 6.4 | | | 30.6 | 26.2 | 17.5 | |
| 8M - MED - 8IT | - 8MO - 2 - 8RT | M8MSEL1/2K | | 1/2 | 6.4 | | | 32.6 | 33.0 | 22.5 | |
| 10M - MED - 4IT | - 10MO - 2 - 4RT | M10MSEL1/4K | 10 | 1/4 | 7.1 | 17.2 | 19.5 | 31.5 | 26.2 | 20.5 | 19 |
| 10M - MED - 6IT | - 10MO - 2 - 6RT | M10MSEL3/8K | | 3/8 | 7.9 | | | 31.5 | 26.2 | 20.5 | |
| 10M - MED - 8IT | - 10MO - 2 - 8RT | M10MSEL1/2K | | 1/2 | 7.9 | | | 33.5 | 33.0 | 22.5 | |
| 12M - MED - 4IT | - 12MO - 2 - 4RT | M12MSEL1/4K | 12 | 1/4 | 7.1 | 22.8 | 22.0 | 36.0 | 28.2 | 20.5 | 22.2 |
| 12M - MED - 6IT | - 12MO - 2 - 6RT | M12MSEL3/8K | | 3/8 | 9.5 | | | 36.0 | 28.2 | 20.5 | |
| 12M - MED - 8IT | - 12MO - 2 - 8RT | M12MSEL1/2K | | 1/2 | 9.5 | | | 36.0 | 33.0 | 22.5 | |
| 12M - MED - 12IT | - 12MO - 2 - 12RT | M12MSEL3/4K | | 3/4 | 9.5 | | | 39.8 | 36.8 | 27.5 | |
| 16M - MED - 6IT | - 16MO - 2 - 6RT | M16MSEL3/8K | 16 | 3/8 | 9.5 | 24.4 | 22.0 | 38.0 | 30.2 | 27.5 | 25.4 |
| 16M - MED - 8IT | - 16MO - 2 - 8RT | M16MSEL1/2K | | 1/2 | 11.9 | | | 38.0 | 35.1 | 27.5 | |
| 18M - MED - 8IT | - 18MO - 2 - 8RT | M18MSEL1/2K | 18 | 1/2 | 11.9 | 24.4 | 22.0 | 39.8 | 36.8 | 27.5 | 30 |
| 18M - MED - 12IT | - 18MO - 2 - 12RT | M18MSEL3/4K | | 3/4 | 15.1 | | | 39.8 | 36.8 | 27.5 | |
| 20M - MED - 8IT | - 20MO - 2 - 8RT | M20MSEL1/2K | 20 | 1/2 | 11.9 | 26.0 | 22.0 | 44.6 | 41.7 | 32 | 32 |
| 20M - MED - 12IT | - 20MO - 2 - 12RT | M20MSEL3/4K | | 3/4 | 15.9 | | | 44.6 | 41.7 | 32 | |
| 22M - MED - 12IT | - 22MO - 2 - 12RT | M22MSEL3/4K | 22 | 3/4 | 15.9 | 26.0 | 22.0 | 44.6 | 41.7 | 32 | 32 |
| 22M - MED - 16IT | - 22MO - 2 - 16RT | M22MSEL1K | | 1 | 18.3 | | | 44.6 | 46.5 | 36 | |
| 25M - MED - 12IT | - 25MO - 2 - 12RT | M25MSEL3/4K | 25 | 3/4 | 15.9 | 31.3 | 26.5 | 49.1 | 41.7 | 36 | 38 |
| 25M - MED - 16IT | - 25MO - 2 - 16RT | M25MSEL1K | | 1 | 21.8 | | | 49.1 | 46.5 | 36 | |

NOTE: 1)The E Dimension is the minimum opening & Fittings of this group may be back drilling to lager ID at pipe thread or straight thread end.
2)Dimension LX, C, D is shown in the finger-tight position. 3)Dimensions are for reference only and are subject to change 4)ISO Tapered (BSPT) thread as per BS 21.
- ALL PART NUMBERS ARE PROPRIETARY OF THEIR RESPECTIVE OWNERS. -