

- Tube Fitting (Double Ferrule)-  
Tube To Male Pipe Thread

# Male Run Tee

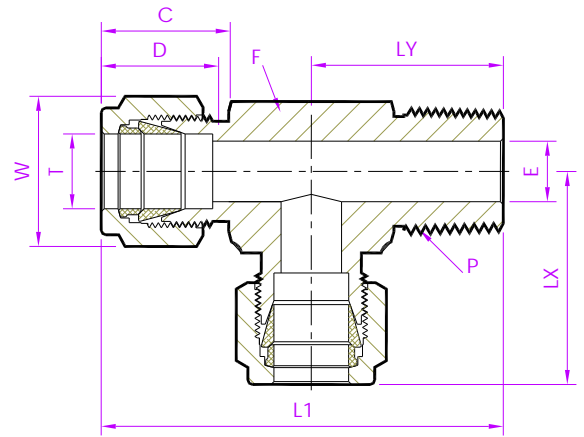

Fractional Tube x NPT (M)

TubeFit Part No.	Equivalent Part No. Type 1	Equivalent Part No. Type 2	TUBE OD Ø T	NPT Male Pipe Size P	ØE	D	C	L1	LX	LY	Body Hex F	Nut Hex W
Dimensions in Inches												
2 - MRTD - 2N	- 200 - 3 - 2TMT	2MRT2N	1/8	1/8	0.09	0.50	0.60	1.63	0.93	0.70	7/16	7/16
2 - MRTD - 4N	- 200 - 3 - 4TMT	2MRT4N		1/4	0.09			1.89	0.97	0.92	9/16	
3 - MRTD - 2N	- 300 - 3 - 2TMT	3MRT2N	3/16	1/8	0.12	0.54	0.63	1.66	0.96	0.70	7/16	1/2
4 - MRTD - 2N	- 400 - 3 - 2TMT	4MRT2N	1/4	1/8	0.19	0.60	0.70	1.80	1.06	0.74	9/16	9/16
4 - MRTD - 4N	- 400 - 3 - 4TMT	4MRT4N		1/4	0.19			1.98	1.06	0.92	9/16	
5 - MRTD - 2N	- 500 - 3 - 2TMT	5MRT2N	5/16	1/8	0.19	0.64	0.73	1.99	1.17	0.82	5/8	5/8
5 - MRTD - 4N	- 500 - 3 - 4TMT	5MRT4N		1/4	0.25			2.18	1.17	1.00	5/8	
6 - MRTD - 4N	- 600 - 3 - 4TMT	6MRT4N	3/8	1/4	0.28	0.66	0.76	2.20	1.20	1.00	5/8	11/16
6 - MRTD - 6N	- 600 - 3 - 6TMT	6MRT6N		3/8	0.28			2.42	1.31	1.11	13/16	
8 - MRTD - 6N	- 810 - 3 - 6TMT	8MRT6N	1/2	3/8	0.38	0.90	0.86	2.53	1.42	1.11	13/16	7/8
8 - MRTD - 8N	- 810 - 3 - 8TMT	8MRT8N		1/2	0.41			2.72	1.44	1.30	7/8	
10 - MRTD - 8N	- 1010 - 3 - 8TMT	10MRT8N	5/8	1/2	0.47	0.96	0.86	2.88	1.50	1.38	7/8	1
12 - MRTD - 12N	- 1210 - 3 - 12TMT	12MRT12N	3/4	3/4	0.62	0.96	0.86	3.02	1.57	1.45	1.1/16	1.1/8
14 - MRTD - 12N	- 1410 - 3 - 12TMT	14MRT12N	7/8	3/4	0.62	1.02	0.86	3.26	1.76	1.45	1.3/4	1.1/4
16 - MRTD - 12N	- 1610 - 3 - 12TMT	16MRT12N	1	3/4	0.62	1.23	1.23	3.60	1.94	1.66	1.3/8	1.1/2
16 - MRTD - 16N	- 1610 - 3 - 16TMT	16MRT16N		1	0.88			3.78	1.94	1.84	1.3/8	

NOTE: 1)The E Dimension is the minimum opening & Fittings of this group may be back drilling to lager ID at pipe thread or straight thread end.  
2)Dimension L1, C, D is shown in the finger-tight position. 3)Dimensions are for reference only and are subject to change 4)NPT thread as per ANSI B 1.20.1.

- ALL PART NUMBERS ARE PROPRIETARY OF THEIR RESPECTIVE OWNERS. -