

- Tube Fitting (Double Ferrule)-
Tube To Male Pipe Thread

Male Run Tee

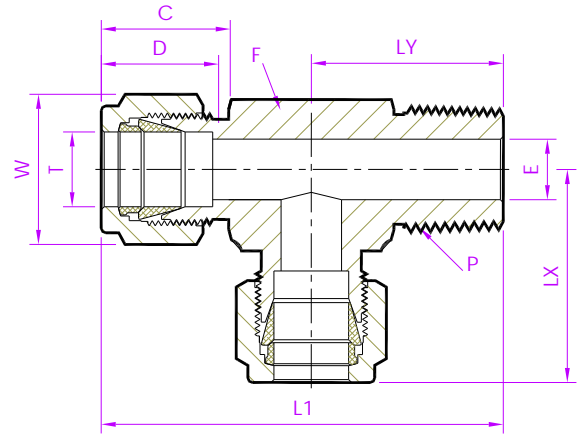

Metric Tube x NPT (M)

Tubefit Part No.	Equivalent Part No. Type 1	Equivalent Part No. Type 2	TUBE OD Ø T	NPT Male Pipe Size P	ØE	D	C	L1	LX	LY	Body Hex F	Nut Hex W
			(mm)	(Inch)	Dimensions in Millimetres							
6M - MRTD - 2N	- 6MO - 3 - 2TMT	M6MRT1/8N	6	1/8	4.8	15.3	17.7	45.8	27.0	18.0	15	14.2
6M - MRTD - 4N	- 6MO - 3 - 4TMT	M6MRT1/4N		1/4	4.8			50.3	27.0	23.4	15	
8M - MRTD - 2N	- 8MO - 3 - 2TMT	M8MRT1/8N	8	1/8	4.8	16.2	18.6	50.7	29.9	20.8	15	16
8M - MRTD - 4N	- 8MO - 3 - 4TMT	M8MRT1/4N		1/4	6.4			55.3	29.9	25.4	15	
10M - MRTD - 4N	- 10MO - 3 - 4TMT	M10MRT1/4N	10	1/4	7.9	17.2	19.5	61.7	33.5	28.2	20.5	19
10M - MRTD - 8N	- 10MO - 3 - 8TMT	M10MRT1/2N		1/2	7.9			66.5	33.5	33.0	22.5	
12M - MRTD - 4N	- 12MO - 3 - 4TMT	M12MRT1/4N	12	1/4	7.1	22.8	22.0	64.2	36.0	28.2	20.5	22
12M - MRTD - 6N	- 12MO - 3 - 6TMT	M12MRT3/8N		3/8	9.5			64.2	36.0	28.2	20.5	
12M - MRTD - 8N	- 12MO - 3 - 8TMT	M12MRT1/2N		1/2	9.5			69.0	36.0	33.0	22.5	
16M - MRTD - 8N	- 16MO - 3 - 8TMT	M16MRT1/2N	16	1/2	11.9	24.4	22.0	73.1	38.0	35.0	27.5	25
16M - MRTD - 16N	- 16MO - 3 - 8TMT	M16MRT1N		1	12.7			93.1	46.6	46.5	36	

NOTE: 1)The E Dimension is the minimum opening & Fittings of this group may be back drilling to lager ID at pipe thread or straight thread end.
2)Dimension L1, C, D is shown in the finger-tight position. 3)Dimensions are for reference only and are subject to change 4)NPT thread as per ANSI B 1.20.1.

- ALL PART NUMBERS ARE PROPRIETARY OF THEIR RESPECTIVE OWNERS. -